

TS1401

APPLICATIONS	Heating, Cooling, Steam applications
MAX. FLOW RATE	With water 40 m ³ /h (DN50) and 50 m ³ /h (DN65)
FRAME	PN16, PN25

MATERIALS	FRAME	Painted carbon steel P355NH (EN 10028/3a) Painted carbon steel ASTM A516 Gr.70 Stainless steel AISI 304L Stainless steel AISI 316L	PLATES	Stainless steel AISI 316L Titanium Alloy SMO 254
	GASKETS	NBR EPDM FKM	CLAMPING BOLTS	Galvanized steel ASTM A193 B7 Stainless steel ASTM A193 B8 Stainless steel ASTM A193 B8M

DIMENSIONS

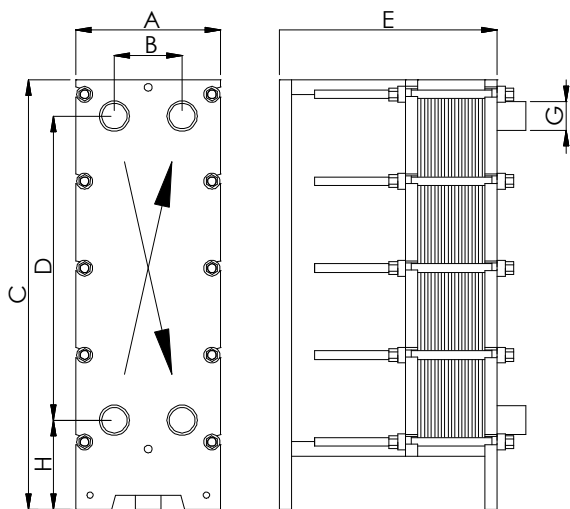

NOMINAL PRESSURE	PN16	PN25
A (mm)	300	311
B (mm)		140
C (mm)		890
D (mm)		630
H (mm)		185
G (mm)	DN50 (2") DN65 (2 1/2")	
Plate surface (m ²)	0,135	
Vol. of channel (l)	0,35	
Weight of plate (Kg)	1,3	
Plate thickness (mm)	0,6	
Weight of frame (Kg)	115	140
Clamping bolts	N°10 M20	N°10 M24
E (mm)	450 (max 57 plates) 670 (max 91 plates) 810 (max 111 plates) 960 (max 135 plates)	

The plate heat exchangers are made according to the **PED 2014/68/UE**

Note: the above quantities can be considered an expanability of 20% for each length. The max quantity of plates for this exchanger is **159**

CONNECTION TYPE

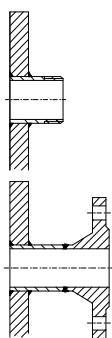

- Male threaded stainless steel (welded) G2"
- Male threaded stainless steel (welded) G2 1/2"

- Flange DN50 (Carbon steel.)
- Flange DN65 (Carbon steel.)

Also available **ANSI**



- Female threaded carbon steel (welded) G2"
- Female threaded carbon steel (welded) G2 1/2"