

TS4201

APPLICATIONS	Heating, Cooling, Steam applications
MAX. FLOW RATE	330 m ³ /h (with water)
FRAME	PN10, PN16, PN25

MATERIALS	FRAME	Painted carbon steel P355NH (EN 10028/3a) Painted carbon steel ASTM A516 Gr.70 Stainless steel AISI 304L Stainless steel AISI 316L	PLATES	Stainless steel AISI 316L Titanium Alloy SMO 254
	GASKETS	NBR EPDM FKM	CLAMPING BOLTS	Galvanized steel ASTM A193 B7 Stainless steel ASTM A193 B8 Stainless steel ASTM A193 B8M

DIMENSIONS

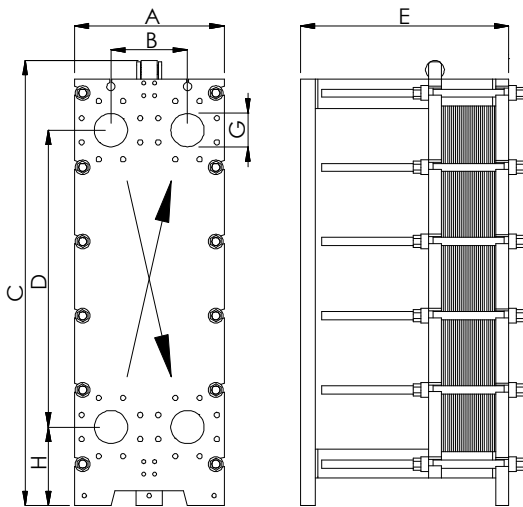

NOMINAL PRESSURE	PN10	PN16	PN25
A (mm)	605	620	640
B (mm)		320	
C (mm)		1536	
D (mm)		960	
H (mm)		299	
G (mm)		DN150 (6")	
Plate surface (m ²)		0,4365	
Vol. of channel (l)		1,2	
Weight of plate (Kg)		4,0	
Plate thickness (mm)		0,6	
Weight of frame (Kg)	540	720	870
Clamping bolts	N°12 M24	N°12 M30	N°12 M36x3
E (mm)	750 (max 89 plates)		
	1000 (max 127 plates)		
	1250 (max 165 plates)		
	1500 (max 203 plates)		
	1750 (max 241 plates)		
	2000 (max 279 plates)		

The plate heat exchangers are made according to the PED 2014/68/UE

Note: the above quantities can be considered an expanability of 20% for each length. The max quantity of plates for this exchanger is 335

CONNECTION TYPE



□ Flange predisposition DN150

Also available ANSI

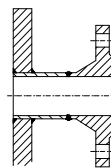

□ Flange DN150 (Carbon steel.)

Also available ANSI